

4

3

2

1

038-00-065
Retaining Ring: Snap, Smalley, Internal, Custom, Ø.923 BORE

241-01-029
Bladder retainer, 011 RC2

210-22-420
Lower Bladder Ring, Snap Ring, 011 RC2

IMPORTANT:
ENSURE RETAINING RING IS FULLY
SEATED INTO GROOVE FULL 360°

REBOUND ASSY

GREASE:
THIN LAYER
ON INNER AND OUTER SEAL BEADS

GREASE:
THIN LAYER OF SLICK HONEY
ON INNER SURFACE

TORQUE:
75±5 IN.LB.

029-08-178
O-Ring [30MM ID x 1.5MM CS] Metric, N-70, Static

TORQUE:
75±5 IN.LB.

GREASE:
THIN LAYER OF SLICK HONEY
ON INNER SURFACE

CARTRIDGE BODY

210-22-391
Bladder, 2011 36_40

TORQUE:
75±5 IN.LB.

820-03-395-KIT
2015 36/40 RC2 Base Valve Assembly

210-22-418
Upper Bladder Ring, 011 RC2

GREASE:
THIN LAYER OF
SLICK HONEY

210-22-867
Topcap, 011 36 Light, RC2

820-03-187-KIT
2011 RC2 Adjuster Assy

IMPORTANT:
VERIFY THAT RETAINING RING
IS COMPLETELY SEATED

038-00-059
Retaining Ring, Internal, VHM-14

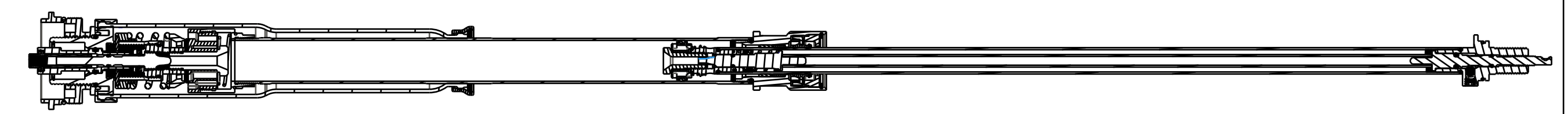

SECTION A-A

| | | | |
|------------------------------|----------|---|------------------|
| | | FOX Factory, Inc. | Ph 831-768-1100 |
| TITLE | | 130 Hangar Way, Watsonville, CA 95076 USA | Fax 831-768-9312 |
| 2015 36 RC2 Cartridge | | | |
| SIZE | DWG. NO. | | |
| C | | | |
| PLOT SCALE 0.50:1 | | SHEET 1 OF 1 | |

PROPRIETARY - THIS DOCUMENT CONTAINS CONFIDENTIAL, PROPRIETARY INFORMATION THAT IS FOX PROPERTY. DO NOT DISCLOSE TO OR DUPLICATE FOR OTHERS EXCEPT AS AUTHORIZED BY FOX.

4

3

2

ProE ASSEM